

EXISTING VENT PIPES TO BE RE —
ROUTED, EXTENDED ABOVE
FINISHED ROOF LEVEL AND VENTED
TO ATMOSPHERE

SITE SURVEY WAS CONDUCTED TO IDENTIFY THE NEED FOR REMOVAL/MOVING OF ROOF TOP EQUIPMENT TO ACCOMMODATE THE NEW ROOF TOP EXTENSION. IN THE EVENT ANY ADDITIONAL SERVICES ARE IDENTIFIED WHICH WERE NOT HIGHLIGHTED ON STRIP OUT DRAWINGS, THE CONTRACTOR SHOULD IDENTIFY A SAFE METHOD OF ISOLATING AND RELOCATING WHERE REQUIRED.

This drawing is a single service drawing showing the concept design. This drawing is not a co-ordinated working/installation drawing and should not be used as such. Any Contractor using this drawing as a working/installation drawing does so at his own risk.

EXISTING CABLE TRAY AND CABLE
ROUTED ACROSS THE ROOF TO BE
ISOLATED, STRIPPED OUT AND
RELOCATED TO NEW ROOF LEVEL

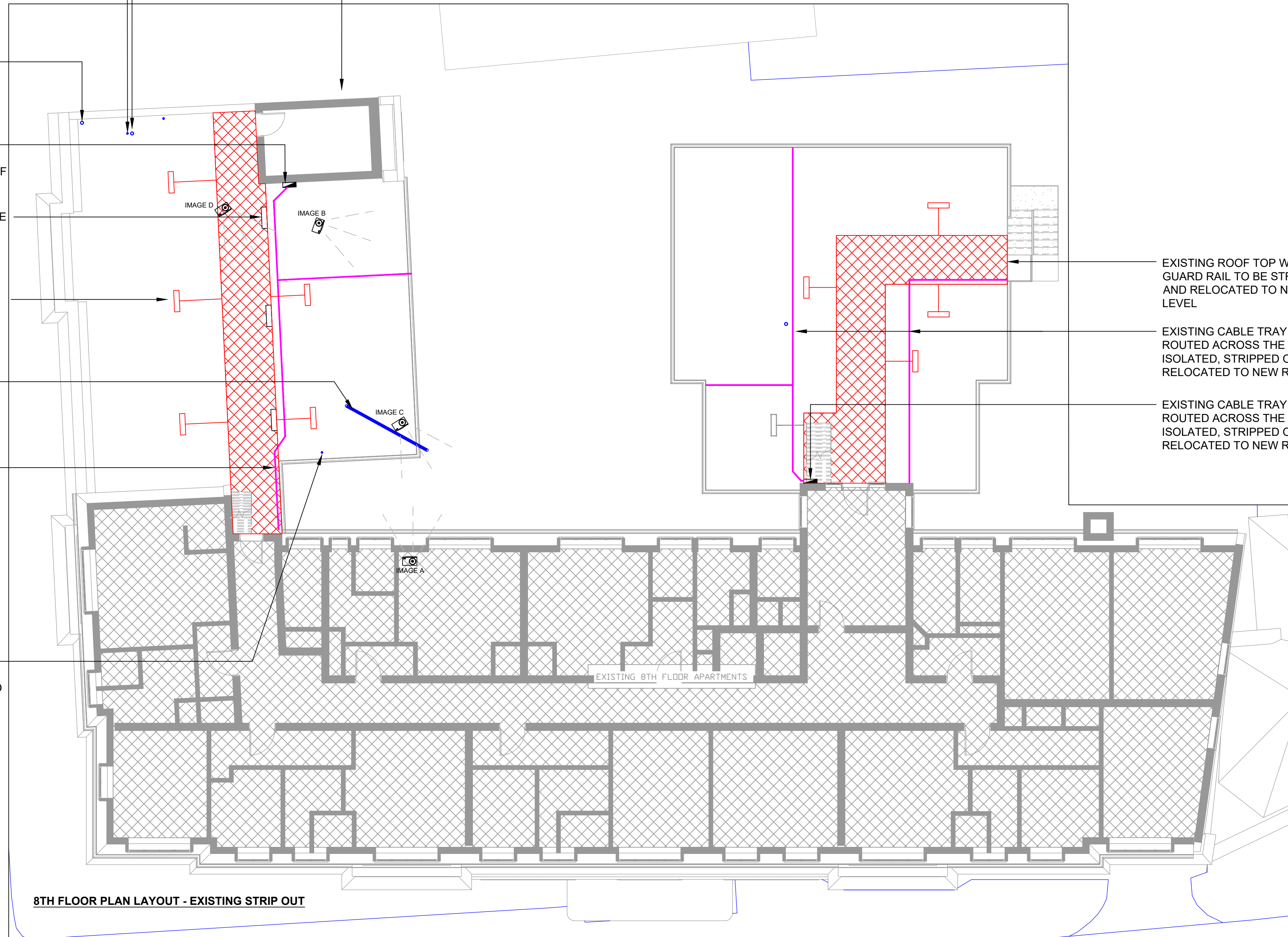

IMAGE D

DRAFT

Vicarage Court
New Rooftop Extension

envision 8-9 Stephen Mews
Fitzrovia
London
W1T 1AF
T: 0207 4860680

A